

USER'S GUIDE



SMH-10102/1020CH2

PROFESSIONAL COMMUNICATION HEADSET

Thank you for choosing Senal.

The Senal communication headsets are ideal for use with wired and wireless communications systems. The cardioid dynamic microphone is optimized for clear and intelligible voice communication, and the around-the-ear, closed-back design assures isolation even in noisy environments.

The SMH-series headphones feature Senal's twist-locking jack allowing compatible cables and accessories to be attached. Senal offers a wide range of accessories to expand the compatibility of your headset.

To attach the cable: ❶ Fully insert the plug. ❷ A quarter-turn clockwise locks the plug into place.

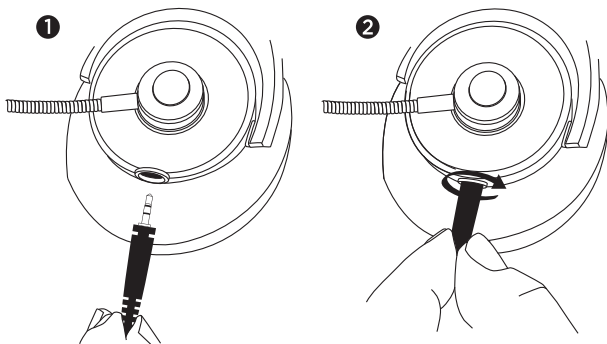

To detach the cable: Turn the plug counterclockwise a quarter-turn and remove it from the jack.

.....

Muting the Microphone

Swivel the gooseneck to the upright position to mute the microphone. Returning the mic back down to the speaking position will unmute it.

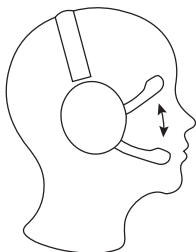

Available Accessories

SMH-H5X2: TRRS to 5-Pin XLR/M

For Telex Systems

SMH-HM3X2: TRRS to M 3.5 mm with 1/4 in. & 3-Pin XLR/M

For connection to mixer or broadcast console

SMH-HMM2: TRRS to M 3.5 mm & Stereo M 3.5 mm for PC

Ideal for gaming on a PC or laptop

SMH-PIGTAIL: TRRS to Unterminated Wire

Attach the connectors you need for your communications system

SMH-H4X2: TRRS to 4-Pin XLR/F

For Portacom/Clear-Com Systems

Specifications

Microphone

Element	Moving coil dynamic
Polar Pattern	Cardioid
Frequency Range	50 Hz to 18 kHz
Sensitivity	-79 dB \pm 3 dB (0 dB = 1 V/microbar, 1 kHz indicated by open circuit)
Impedance	200 Ω \pm 30% @1 kHz

Headphone

Speaker Dimension	40 mm
Magnet Type	Neodymium
Frequency Range	20 Hz to 20 kHz
Sensitivity	87 dB (SMH-1010CH2) 84 dB (SMH-1020CH2)
Nominal input power	20 mW
Max. Input Power	40 mW
Impedance	400 Ω (SMH-1010CH2) 200 Ω parallel (SMH-1020CH2)
Distortion	\leq 5%

Warning

Protect your hearing!

Exposure to high sound pressure levels may cause permanent hearing loss. Avoid listening at high volumes for extended periods.

Symptoms of noise-induced hearing loss may include persistent ringing, pain, itching, or inflammation of the ears, and difficulty understanding speech.

For more information, visit

<http://www.osha.gov/SLTC/noisehearingconservation/>

<http://www.cdc.gov/niosh/topics/noise/>

Please note: Government URLs are subject to change. If these links don't connect you to the right information, visit www.cdc.gov and www.osha.gov or do an Internet search for the phrase "hearing loss."

Three-Year Limited Warranty

This SENAL product is warranted to the original purchaser to be free from defects in materials and workmanship under normal consumer use for a period of three (3) years from the original purchase date or thirty (30) days after replacement, whichever occurs later. The warranty provider's responsibility with respect to this limited warranty shall be limited solely to repair or replacement, at the provider's discretion, of any product that fails during normal use of this product in its intended manner and in its intended environment. Inoperability of the product or part(s) shall be determined by the warranty provider. If the product has been discontinued, the warranty provider reserves the right to replace it with a model of equivalent quality and function.

This warranty does not cover damage or defect caused by misuse, neglect, accident, alteration, abuse, improper installation or maintenance. EXCEPT AS PROVIDED HEREIN, THE WARRANTY PROVIDER MAKES NEITHER ANY EXPRESS WARRANTIES NOR ANY IMPLIED WARRANTIES, INCLUDING BUT NOT LIMITED TO ANY IMPLIED WARRANTY OF MERCHANTABILITY OR FITNESS FOR A PARTICULAR PURPOSE. This warranty provides you with specific legal rights, and you may also have additional rights that vary from state to state.

To obtain warranty coverage, contact the Senal Customer Service Department to obtain a return merchandise authorization ("RMA") number, and return the defective product to Senal along with the RMA number and proof of purchase. Shipment of the defective product is at the purchaser's own risk and expense.

For more information or to arrange service, visit www.senalsound.com or call Customer Service at 212-594-2353.

Product warranty provided by the Gradus Group.
www.gradusgroup.com

Senal is a registered trademark of the Gradus Group.

© 2023 Gradus Group LLC. All Rights Reserved.

