

**Z207 BLUETOOTH®  
COMPUTER SPEAKERS  
HAUT-PARLEURS Z207 BLUETOOTH®  
POUR ORDINATEUR**

Complete Setup Guide  
Guide d'installation complet

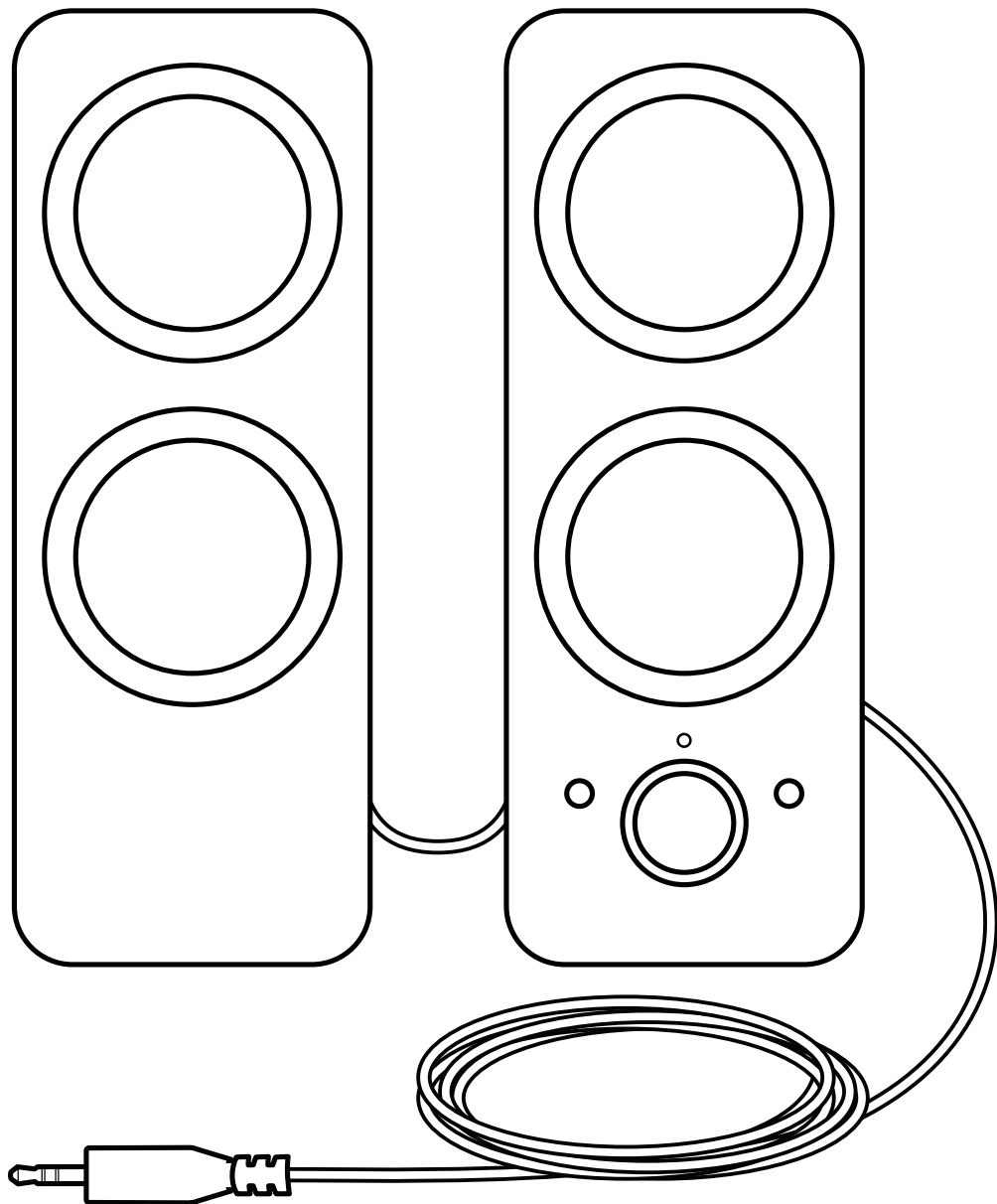

**logitech®**

**KNOW YOUR PRODUCT**

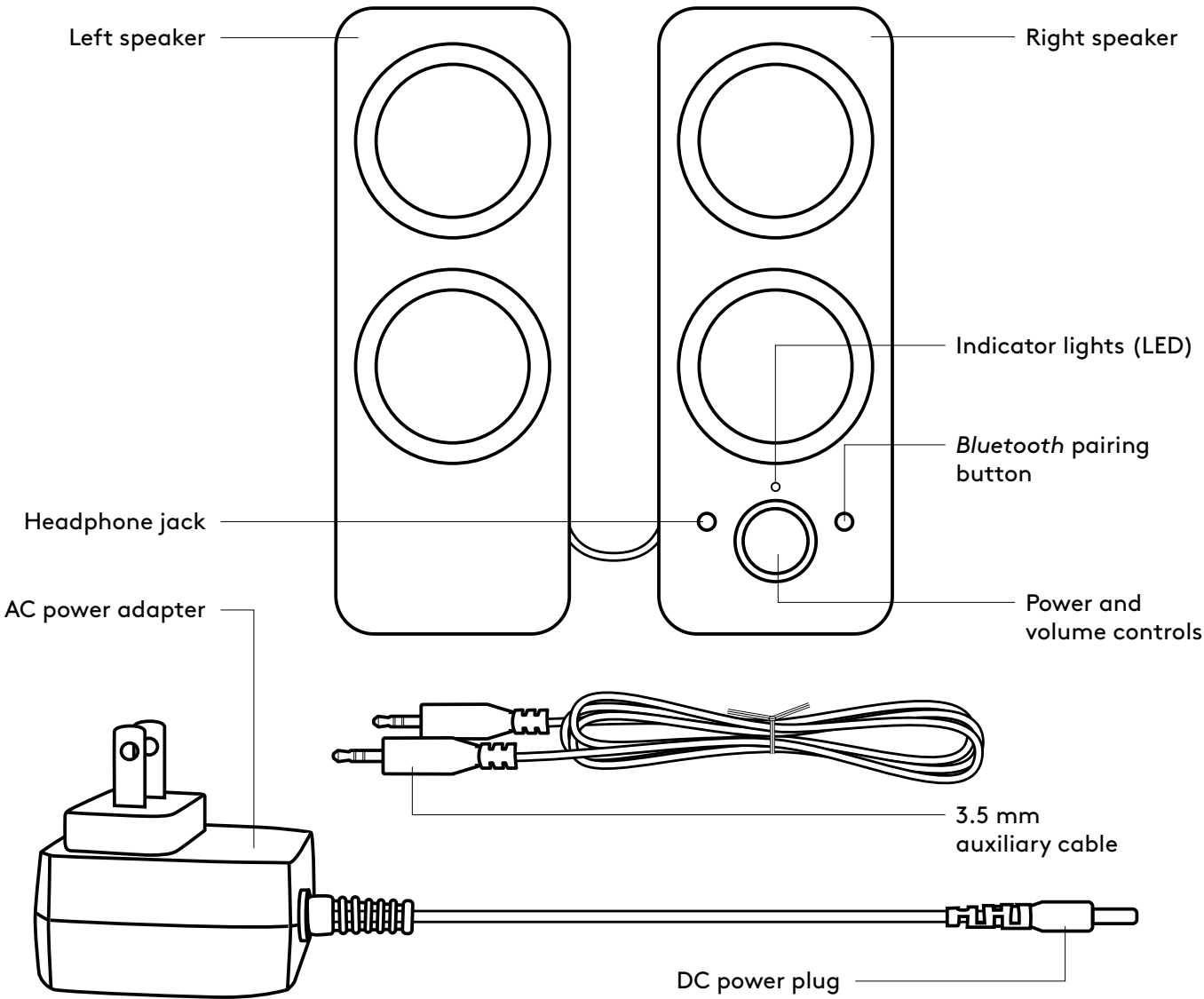

## CONNECT THE SPEAKERS

1. Connect the DC power plug to the back of your right speaker and connect your AC adapter to the electrical outlet.
2. Connect to the 3.5 mm audio jack on your source device using the 3.5mm auxiliary input on the back of the right speaker.
3. (Optional) Connect your headphones to the headphone jack at the front of the right speaker.
4. Turn the speaker on using the power knob.
5. To pair your devices with speakers using *Bluetooth*, press the *Bluetooth* pairing button for 3 seconds until the LED starts blinking. Turn on *Bluetooth* on your device and select "Logi Z207" to connect to it. The LED will then turn to a steady blue light after pairing.

1

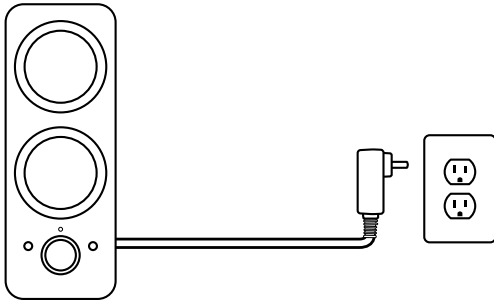

2

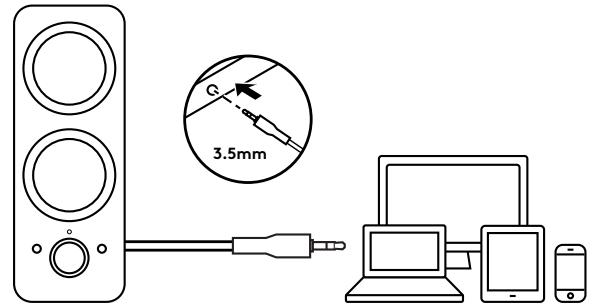

3

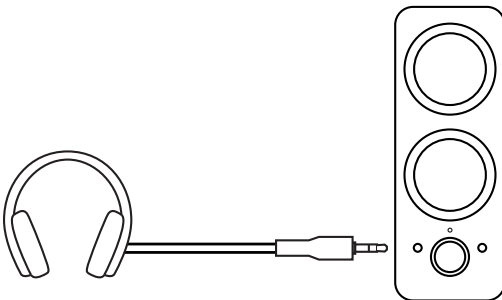

4

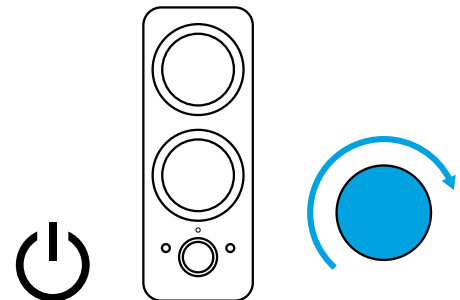

5

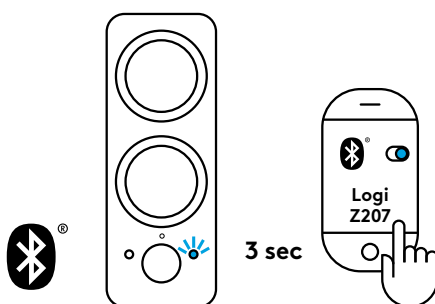

## ADJUST THE VOLUME

1. Increase (or decrease) the volume of speakers by rotating the volume control knob clockwise (or counter-clockwise) on the right speaker.

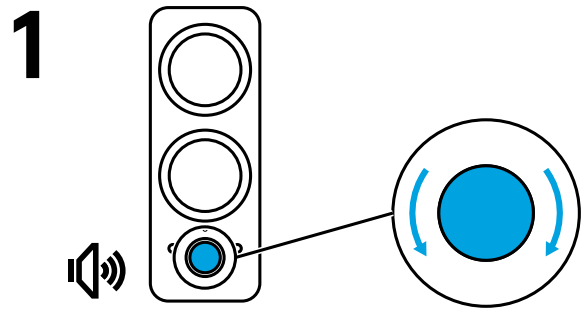

[www.logitech.com/support/Z207](http://www.logitech.com/support/Z207)

© 2019 Logitech. Logitech, Logi and other Logitech marks are owned by Logitech and may be registered. All other trademarks are the property of their respective owners. Logitech assumes no responsibility for any errors that may appear in this manual. Information contained herein is subject to change without notice.