

S150 USB STEREO SPEAKERS

HAUT-PARLEURS STÉRÉO USB S150

Complete Setup Guide
Guide d'installation complet

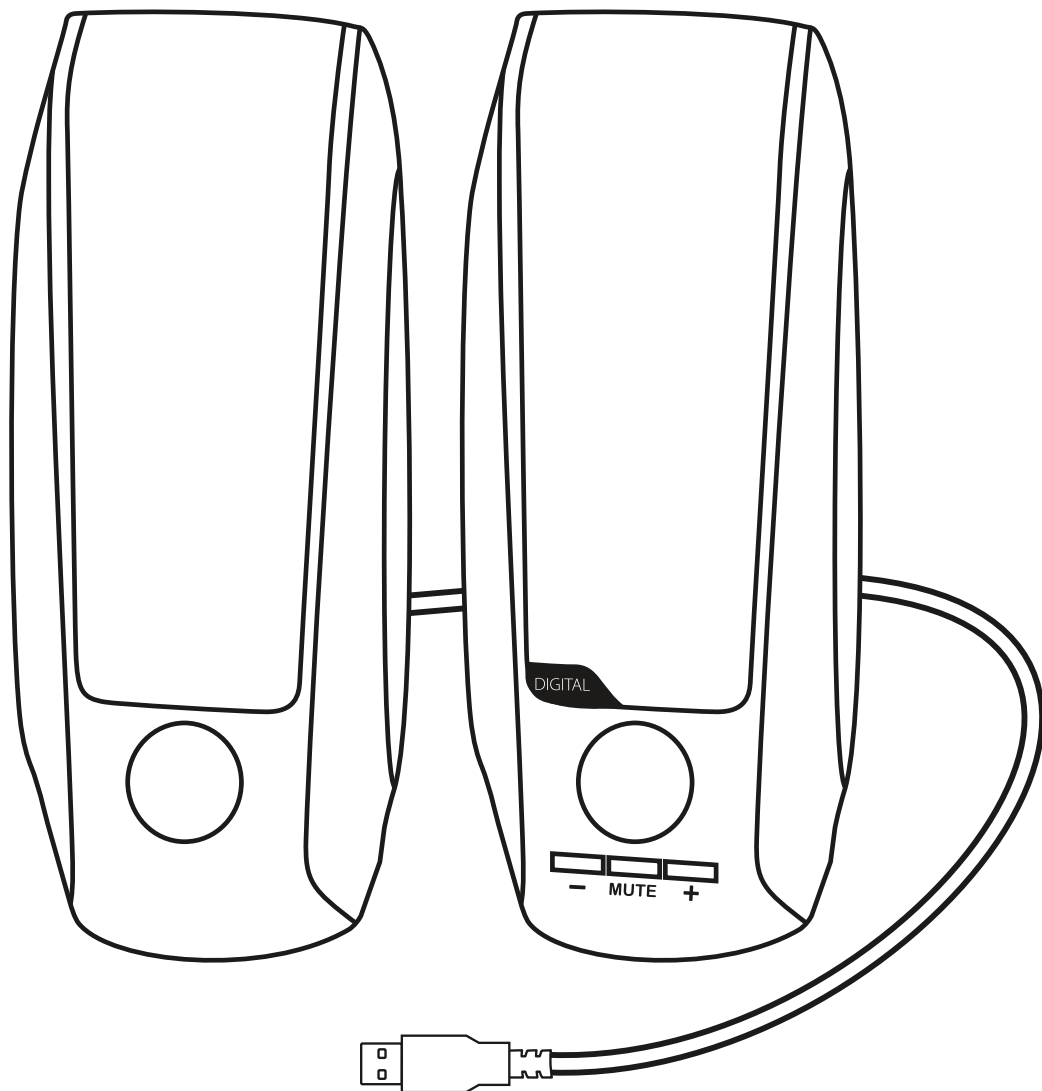

logitech®

KNOW YOUR PRODUCT

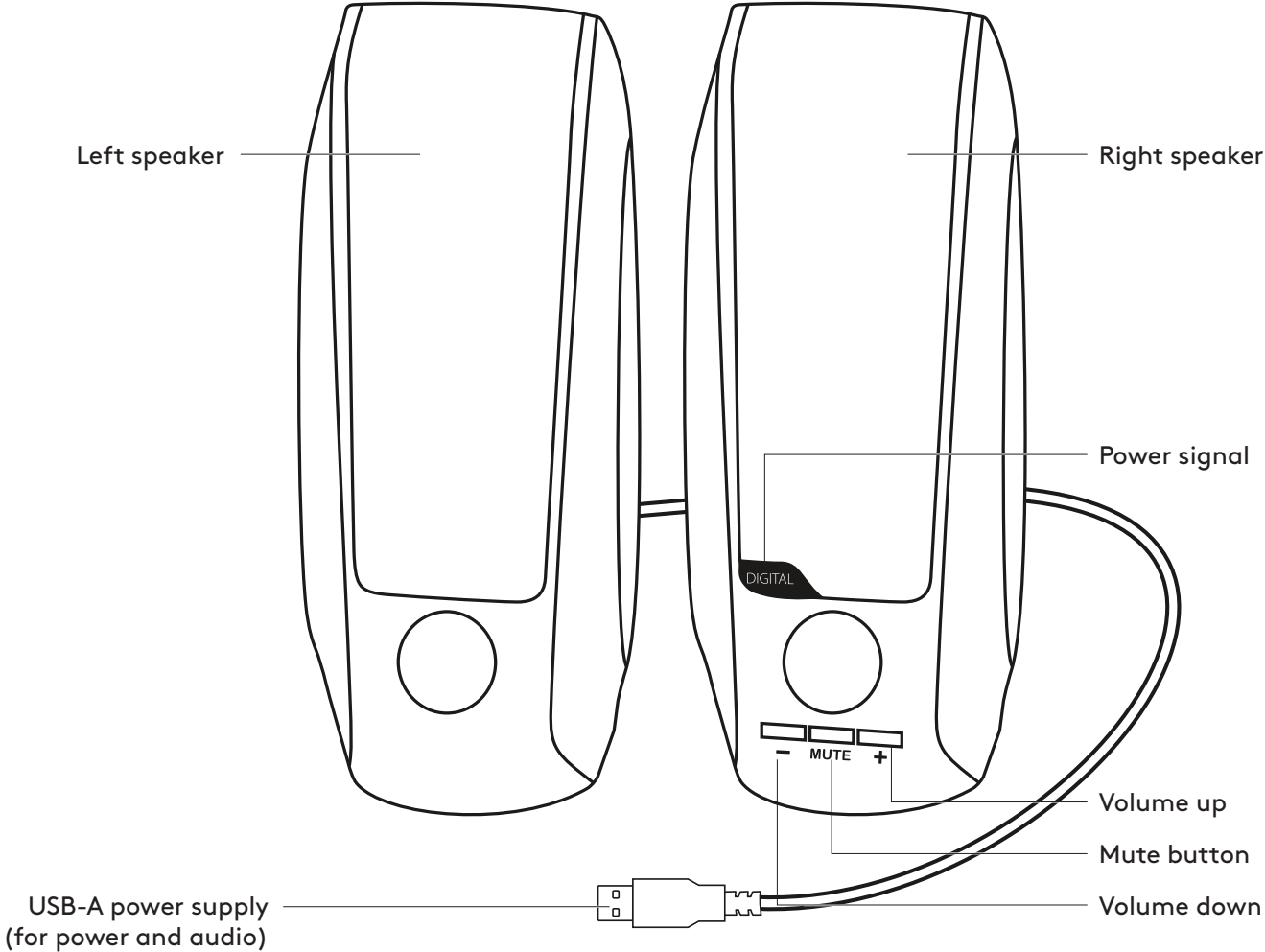

CONNECT THE SPEAKERS

1. Connect the USB-A power cable to your device for power and audio.
2. When the power is on, there will be an orange light signal on your right speaker.

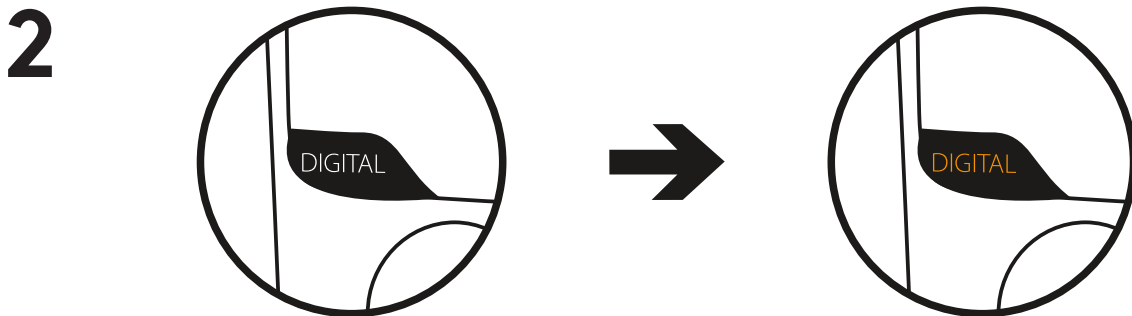
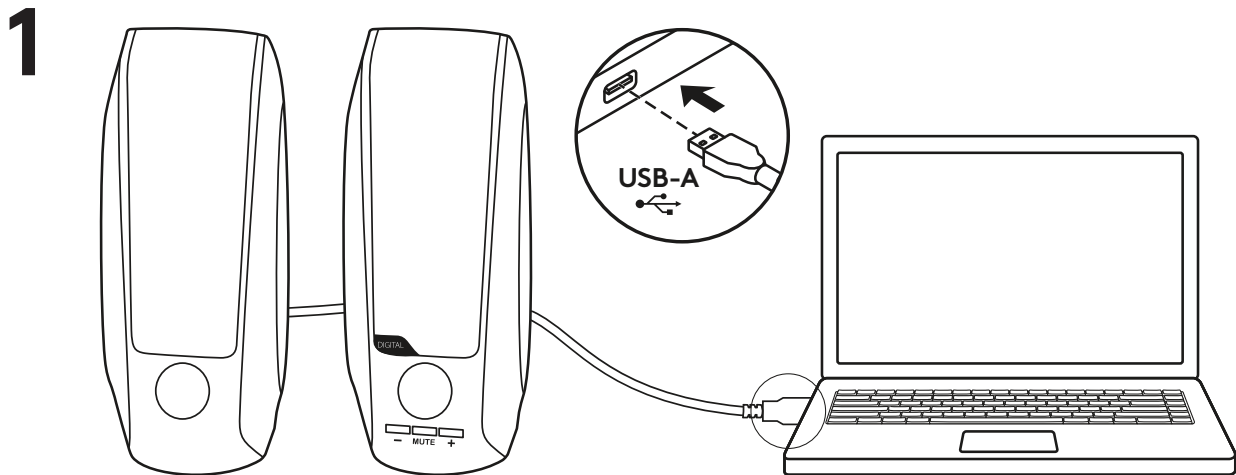

ADJUST THE VOLUME

1. Increase (or decrease) the volume of speakers by pressing the + or - buttons.
2. Mute by pressing the middle button.

1

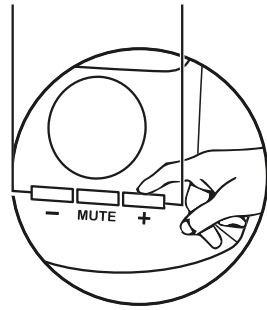
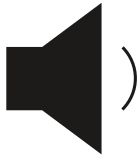

2

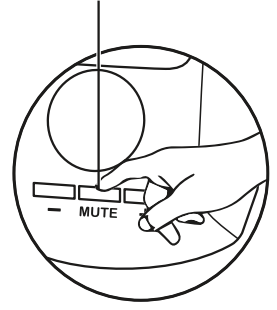
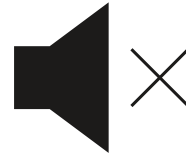

www.logitech.com/support/S150